

TECHNICAL DATA SHEET

20W CC DRIVER

Output Rating: 18 - 24V, 750mA

Model No: ECA15V60030A080-S



Input Specifications

S. No.	Parameter	Specification
1.	Nominal Input Voltage	240Vac, Single Phase
2.	Operating Frequency Range	47Hz to 60Hz
3.	Performance Input Voltage Range	140Vac - 285Vac
4.	Input Wattage	20W \pm 3W
5.	Input Current @ 240Vac	95mA (Maximum)
6.	Total Harmonic Distortion @ 240Vac	< 10%
7.	Power Factor	> 0.95

Output Specifications

S. No.	Parameter	Specification
1.	Output Voltage range	18V-24V
2.	Output Current	750 mAmp \pm 5%
3.	LED Current Regulation from input Voltage 140Vac to 285Vac	\pm 5%
4.	Output Voltage Ripple (Peak to Average)	< 10%
5.	Output Current Ripple (Peak to Average)	< 30%

General Specifications

S. No.	Parameter	Specification
1.	Driver Efficiency	> 85%
2.	Electrical Class	Class II
3.	Ingress Protection	IP65
4.	Operational Temperature Range	-10°C to 50°C Ambient
5.	Max Case Temperature @ Tc point	80°C
6.	Case Temperature @ Tc point for warranty	70°C
7.	Product Life @ Tc 70°C	50000 Hours
	Product Life @ Tc 80°C	25000 Hours
8.	RoHS Compliance	Yes

Protections and Driver Safety:

S. No.	Parameter	Specification
1.	Output Open Circuit Protection	Provided
2.	Output Short Circuit Protection	Provided
3.	Input High Voltage Cut-off	320V \pm 10V
	Input High Voltage Reconnect	300V \pm 10V
	Input 440V withstanding	>48 Hours
4.	Input Low Voltage ON Point	> 70Vac
	Input Low Voltage current fold-back	< 130Vac
5.	Over Temperature Protection (current fold-back)	> 80°C (Optional)
6.	Isolation between Input to Output	1.5KV
7.	Insulation Resistance	> 10MOhms
8.	Surge Protection(Differential Mode)	6KV
	Surge Withstanding (No of 5KV Pulses)	>500

Other Specifications

S. No.	Parameter	Specification
1.	Housing Material	Polycarbonate
2.	Dimensions(mm)	63mm x 58mm x 30mm (L x B x H)
3.	Weight	~210 grams
4.	Input Connection	Phase: 20/19/32, PTFE Wire, White Neutral: 20/19/32, PTFE Wire, White
	Output Connection	LED '+': 20/19/32, PTFE Wire, Red LED '-': 20/19/32, PTFE Wire, Black

TECHNICAL DATA SHEET

20W CC DRIVER

Output Rating: 18 - 24V, 750mA

Model No: ECA15V60030A080-S

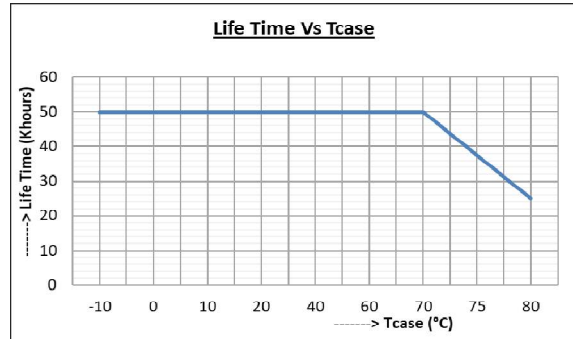
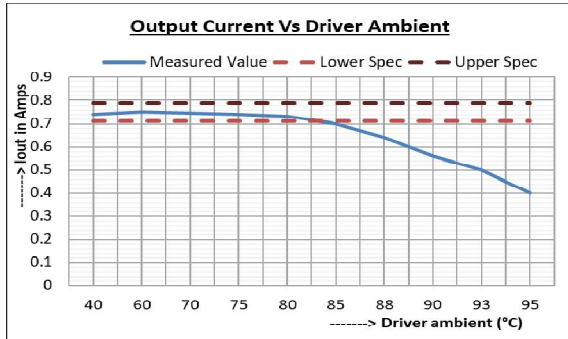
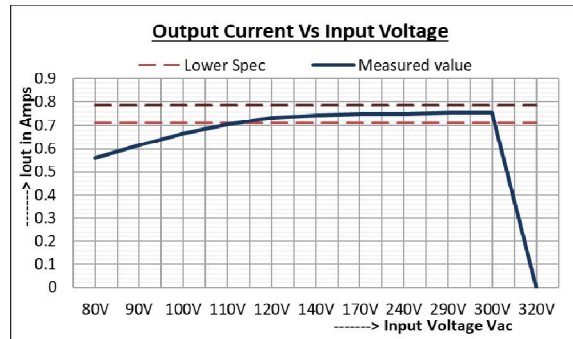
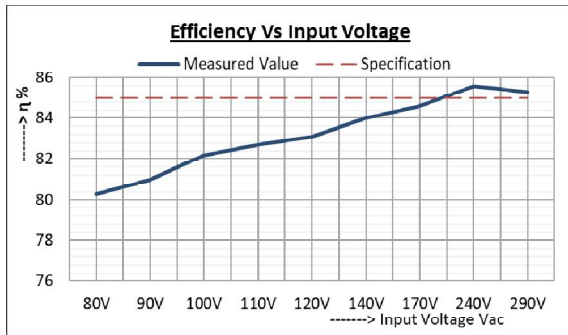
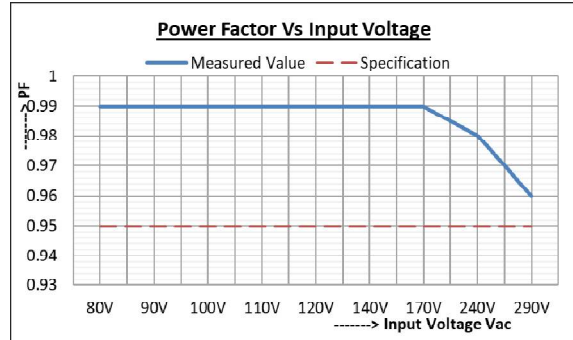
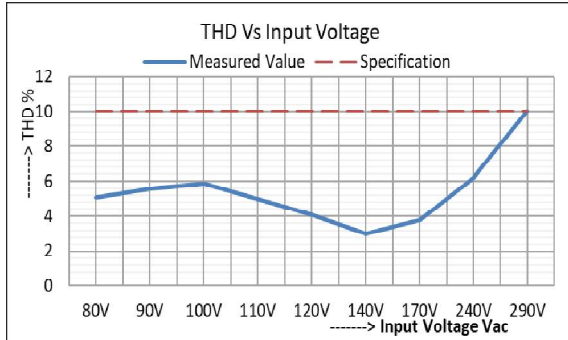

Typical trend of Different Parameters:

Dimensional Drawing:

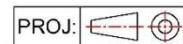
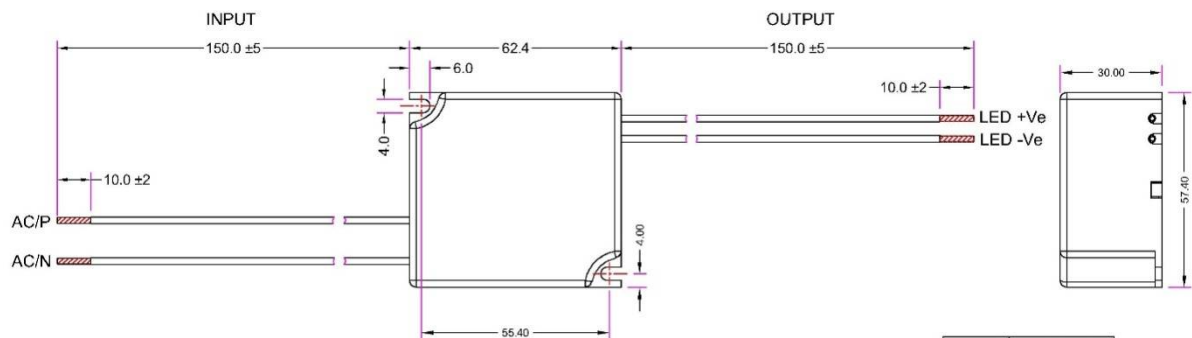

Unspecified tolerances: ±1mm.
All Dimensions are in mm.